

NOTICE OF RECEIPT OF COMPLETE APPLICATION

pursuant to Section 34(12)
of the Planning Act, R.S.O. 1990, as amended

APPLICATION FOR ZONE CHANGE

TOWNSHIP OF NORWICH

Please be advised that the Community Planning Office has received an application applying to the following lands:

File No.:	ZN 3-26-03
Owner:	Estate of Hedwig Stockmans (c/o Ted Stockmans)
Location of Property:	The subject lands are described as Part of Lot 8, Concession 11 (South Norwich), in the Township of Norwich. The subject lands are located at the southeast corner of New Road and Coal Line; the subject lands have no municipal address but can be located at PIN: 00048-0026.
Description of Application:	The purpose of this application is to rezone the subject lands from 'General Agricultural Zone (A2)' to a 'Special General Agricultural Zone (A2-sp)' to permit a single detached dwelling to be constructed on an undersized agricultural parcel (approximately 0.84 ha (2.07 ac) in size) within a 0.4 ha (1 ac) building envelope. The applicant is proposing to rezone the subject lands to permit a future dwelling serviced by private septic and well on the subject lands.

(see attached map)

Please note this is **not** a notice of Public Meeting. Prior to the Public Meeting, you will receive a "Public Notice" informing you of the date, time and location of the public meeting, together with a description of the proposal.

If you have any questions regarding the application, please contact this office to arrange an appointment with **Amy Hartley, Development Planner**. Written inquiries may also be forwarded to the regular mail or email addresses provided below. Please include the applicant's name and file number on all correspondence.

Amy Hartley
Development Planner
Community Planning
County of Oxford
P. O. Box 1614, 21 Reeve Street
Woodstock ON N4S 7Y3
phone: 519-539-9800 x 3204
email: planning@oxfordcounty.ca

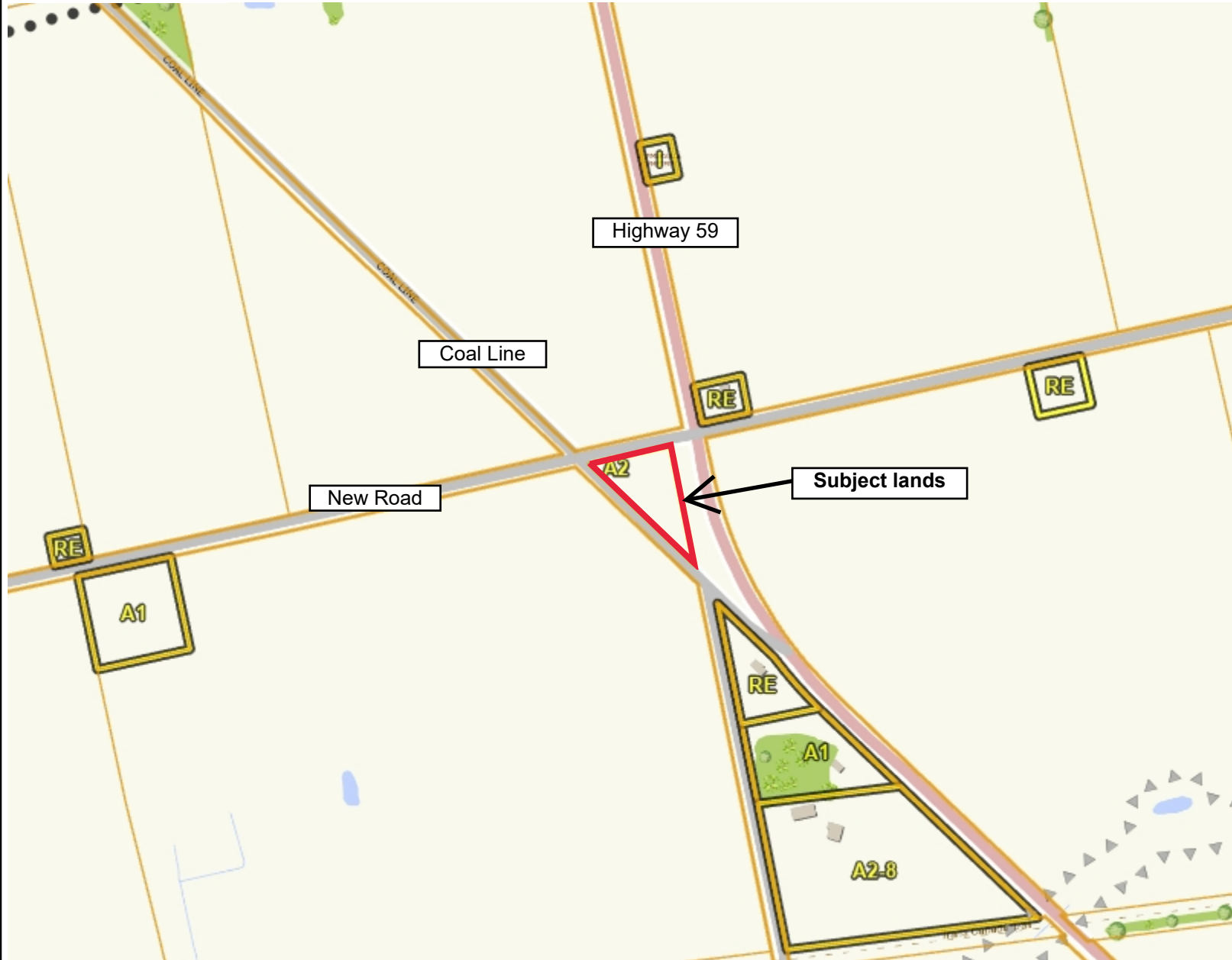

Legend

- Parcel Lines**
 - Municipal Boundary
 - Property Boundary
 - Assessment Boundary
 - Road
 - Unit
- Zoning Floodlines**
- Regulation Limit**
 - ◆ 100 Year Flood Line
 - ▲ 30 Metre Setback
 - Conservation Authority Regulation Limit
 - Regulatory Flood And Fill Lines
- Land Use Zoning (Displays 1:16000 to 1:500)

Notes

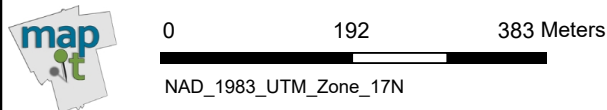

This map is a user generated static output from an Internet mapping site and is for reference only. Data layers that appear on this map may or may not be accurate, current, or otherwise reliable. This is not a plan of survey

April 27, 2026